

FILTER INSERT REPLACEMENT

INSTALLATION GUIDE

HDU 15/25





Filter Insert Replacement

CJC™ Fine Filter HDU 15/25

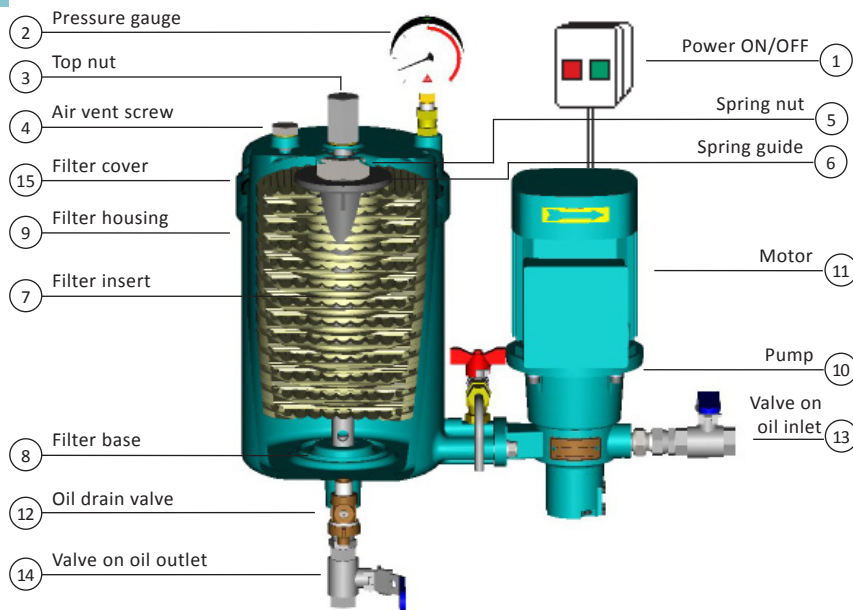

Keep filter insert in plastic bag until use

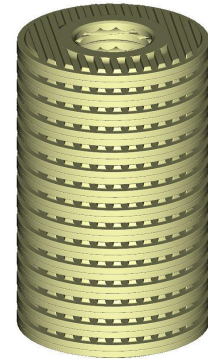

7 Filter insert

FILTER INSERT REPLACEMENT

- 1 Stop filter
- 2 Close valve on oil inlet
- 3 Close valve on oil outlet
- 4 Open air vent screw
- 5 Open oil drain valve and drain waste oil into container
- 6 Unscrew top nut
- 7 Lift off filter cover
- 8 Unscrew spring nut
- 9 Remove spring and spring guide
- 10 Remove used filter insert
- 11 Ensure filter base is clean
- 12 Install new filter insert
- 13 Mount spring guide carefully - make sure there is no contact between O-ring and thread
- 14 Tighten spring nut
- 15 Tighten spring nut until spring guide is level with top edge of filter housing. Tightening torque minimum 4 Nm / 3 ft lbf
- 16 Replace O-ring and mount filter cover
- 17 Replace O-ring and mount filter cover. Replace O-ring and mount filter cover. Replace O-ring and mount filter cover. Tighten top nut with torque of 70 Nm / 50 ft lbf
- 18 Replace O-ring and mount filter cover. Replace O-ring and mount filter cover. Replace O-ring and mount filter cover. Tighten top nut with torque of 10 Nm / 7 ft lbf

All disposal according to environmental regulation!

PF1201 - 14.10.2013